

FMF 600



FMFX 680



FMFS 640



FMF600

FMFX680

FMFS640

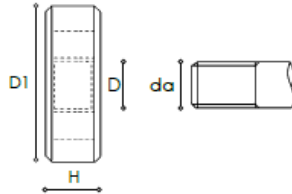

D	da	D1	H	CODE	HSS 5600..... €	HSS-E 5680..... €	HSS 5640..... €
MF 2 x 0,25	1,95	16	500002	34,47		
MF 2,5 x 0,35	2,44	16	500025	34,47		
MF 3 x 0,35	2,94	20	500003	24,65		38,49
MF 3,5 x 0,35	3,44	20	500035	24,65		38,49
MF 4 x 0,5	3,93	20	500004	24,65		37,11
MF 4,5x 0,5	4,43	20	500045			37,11
MF 5 x 0,5	4,90	20	500005	24,65		37,11
MF 5,5 x 0,5	5,43	20	500055	24,65		37,11
MF 6 x 0,75	5,90	20	700006	24,65		33,51
MF 7 x 0,75	6,90	25	900007	26,44		40,84
MF 8 x 0,75	7,90	25	907508	26,44		36,14
MF 8 x 1	7,88	25	910008	26,44	34,23	36,14
MF 9 x 0,75	8,90	25	907509	27,47		
MF 9 x 1	8,88	25	910009	27,47		38,72
MF 10 x 0,75	9,90	30	1175010	34,47		
MF 10 x 0,75	9,90	30	1107510			44,73
MF 10 x 1	9,88	30	1110010	34,20	42,51	50,54
MF 10 x 1,25	9,86	30	1112510	34,20		50,54
MF 11 x 0,75	10,90	30	1107511	42,23		
MF 11 x 1	10,88	30	1110011	42,23		62,58
MF 11 x 1,25	10,86	30	1112511			62,58
MF 12 x 1	11,88	38	1010012	42,23		58,85
MF 12 x 1,25	11,86	38	1012512	41,68	55,70	58,85
MF 12 x 1,5	11,85	38	1015012	41,68	55,70	58,85
MF 14 x 1	13,88	38	1010014	42,23		60,12
MF 14 x 1,25	13,86	38	1012514	42,23		60,12
MF 14 x 1,5	13,85	38	1015014	41,68	55,98	60,12
MF 15 x 1	14,88	38	1010015	57,46		65,21
MF 15 x 1,5	14,85	38	1015015	57,46		65,21
MF 16 x 1	15,88	45	1410016	59,95		85,16
MF 16 x 1,25	15,86	45	1412516	58,71		
MF 16 x 1,5	15,85	45	1415016	59,41	83,27	85,16
MF 18 x 1	17,88	45	1410018	59,95		85,16
MF 18 x 1,5	17,85	45	1415018	59,41	83,27	85,16
MF 18 x 2	17,80	45	1420018	59,41		
MF 20 x 1	19,88	45	1410020	61,90		88,98
MF 20 x 1,5	19,85	45	1415020	61,90	91,85	88,98

FILIERE CON IMBOCCO CORRETTO DIES WITH SPIRAL POINT SCHNEIDEISEN MIT
 SCHÄLANSCHNITT CON FILIERES AVEC ENTREE "GUN" TERRAJAS CON ENTRADA CORREGIDA



FMF 600

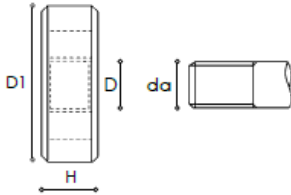

FMFX 680
INOX



FMFS 640

FMF600
FMFX680
FMFS640

D	da	D1	H	CODE	HSS 5600..... €	HSS-E 5680..... €	HSS 5640..... €
MF 20 x 2	19,80	45	1420020	61,90		
MF 22 x 1	21,88	55	1610022	92,08		129,05
MF 22 x 1,5	21,85	55	1615022	91,25	139,16	129,05
MF 22 x 2	21,80	55	1620022	91,25		
MF 24 x 1	23,88	55	1610024	96,79		137,92
MF 24 x 1,5	23,85	55	1615024	96,79	143,72	137,92
MF 24 x 2	23,80	55	1620024	96,79		
MF 25 x 1,5	24,85	55	1615025	126,28		
MF 25 x 2	24,80	55	1620025	126,28		
MF 26 x 1,5	25,85	55	1615026	126,28		
MF 26 x 2	25,80	55	1620026	126,28		
MF 27 x 1	26,88	65	1810027			191,78
MF 27 x 1,5	26,85	65	1815027	128,91		191,78
MF 27 x 2	26,80	65	1820027	128,91		
MF 28 x 1,5	27,85	65	1815028	128,91		191,78
MF 28 x 2	27,80	65	1820028	128,91		191,78
M 30 x 1	29,85	65	1810030	131,43		202,84
MF 30 x 1,5	29,85	65	1815030	131,43		202,84
MF 30 x 2	29,80	65	1820030	131,43		
MF 32 x 1,5	31,85	65	1815032	131,71		
MF 32 x 2	31,82	65	1820032	131,71		
MF 33 x 1,5	32,85	65	1815033	136,35		
MF 33 x 2	32,82	65	1820033	136,35		
MF 36 x 1,5	35,85	65	1815036	142,28		
MF 36 x 2	35,82	65	1820036	142,28		
MF 36 x 3	35,76	65	2530036	142,28		
MF 39 x 1,5	38,85	75	2015039	191,72		
MF 39 x 2	38,82	75	2020039	191,72		
MF 39 x 3	38,76	75	3030039	191,72		
MF 40 x 1,5	39,85	75	2015040	191,72		
MF 40 x 2	39,82	75	2020040	191,72		
MF 40 x 3	39,76	75	3030040	191,72		
MF 42 x 1,5	41,85	75	2015042	195,51		
MF 42 x 2	41,82	75	2020042	195,51		
MF 42 x 3	41,76	75	3030042	195,51		
MF 45 x 1,5	44,85	90	2215045	310,60		
MF 45 x 2	44,82	90	2220045	310,60		
MF 45 x 3	44,76	90	3630045	310,60		
MF 48 x 1,5	47,85	90	2215048	310,60		
MF 48 x 2	47,82	90	2220048	310,60		
MF 48 x 3	47,76	90	3630048	310,60		

FMF 600    **6g**

FMFX 680    **6g**

FMFS 640    **6g**

FMF600 **FMFX680** **FMFS640**

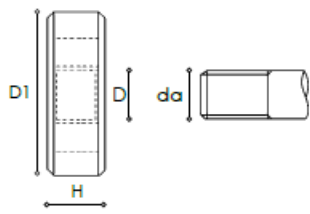

D	da	D1	H	CODE	HSS 5600..... €	HSS-E 5680..... €	HSS 5640..... €
MF 50 x 1,5	49,85	90	2215050	322,71		
MF 50 x 2	49,82	90	2220050	322,71		
MF 50 x 3	49,76	90	3630050	322,71		
MF 52 x 1,5	51,85	90	2215052	380,08		
M 52 x 2	51,82	90	2220052	380,08		
M 52 x 3	51,76	90	3630052	380,08		